

REAR ELEVATION



NOTE: EXTERIOR FINISH BY OTHERS

FRONT ELEVATION

RESERVED DESIGN PROFESSIONAL SEAL

QUALITY ASSURANCE AGENCY APPROVAL STAMP

RESERVED FOR NEW YORK STATE APPROVAL STAMP



LEFT ELEVATION



RIGHT ELEVATION

RESERVED DESIGN PROFESSIONAL SEAL
QUALITY ASSURANCE AGENCY APPROVAL STAMP
RESERVED FOR NEW YORK STATE APPROVAL STAMP

PELLA DOORS AND WINDOWS (DESIGNER SERIES WITH SHADES)

	R.O. SIZE	LIGHT	VENT	MAX. RM. (SQ.FT.)**	EGRESS SIZE	U-VALUE	INFILTRATION	DP
3765	37 3/4"x65 3/4"	12.5	6.7	180.0	33 13/16 x 28 7/8	.34	0.3 CFM	40
2565	25 3/4"x65 3/4"	7.7	4.3	96.25	N/A	.34	0.3 CFM	40
3765-2	74 3/4"x65 3/4"	25.0	13.4	320	33 13/16 x 28 7/8	.34	0.3 CFM	40
2565-2	50 3/4"x65 3/4"	14.4	8.6	192.5	N/A	.34	0.3 CFM	40
6584	65 3/4"x84 3/4"	29.8	0	0	N/A	.34	0.3 CFM	40
3735	37 3/4"x37 3/4"	6.0	3.2	75.0	N/A	.34	0.3 CFM	40
2947	29 3/4"x47 3/4"	6.4	3.5	80.0	N/A	.34	0.3 CFM	40
2915	29 3/4"x15 3/4"	1.3	0	N/A	N/A	.34	0.3 CFM	40
2917	29 3/4" X 17 3/4"	1.8	0	N/A	N/A	.34	0.3 CFM	50
2517	25 3/4" X 17 3/4"	1.5	0	N/A	N/A	.34	0.3 CFM	50
3717	37 3/4" X 17 3/4"	2.4	0	N/A	N/A	.34	0.3 CFM	50
7282 IN SWING	72 1/2" X 83"	20.9	36.9	261.25	31 1/8" x 78 1/8"	.33	0.15 CFM	25
3068 SWINGING DR.	36"x82"	0	18.9		35 1/16" x 79 1/16"	.30	0.07 CFM/FT	50
6068 OUT SWING	62 1/2" X 83"	15.5	30.5	193.8	24 13/16" x 78 3/16"	.34	0.15 CFM	50

LIGHT, VENT AND ROOM FINISHES

ROOM	AREA	LIGHT REQ'D	LIGHT PROVIDED	VENT REQ'D	VENT PROVIDED	ROOM FINISH
NOOK	193	15.44	69.1	7.72	58.9	DRYWALL PAINTED
KITCHEN	271	21.68	6.0	10.84	3.2	DRYWALL PAINTED
LIVING ROOM	308	24.64	30.9	12.32	15.3	DRYWALL PAINTED
DINING ROOM	313	25.04	63.1	12.52	24.4	DRYWALL PAINTED
FAMILY ROOM	500	40.48	44.7	20.24	20.1	DRYWALL PAINTED
BATH 4	52	3.0	6.4	1.5	50 CFM	DRYWALL PAINTED

*** KITCHEN IS COMBINED WITH NOOK AND REQUIRES 37.12 SF OF LIGHT AND 18.56 SF OF VENTILATION. PROVIDED LIGHT = 75.1 SF, AND 62.1 SF OF VENTILATION

ALL WINDOWS ARE NFRC CERTIFIED
FOR WIND BORNE DEGREE WINDOWS ARE TO BE PROTECTED WITH PLYWOOD PANELS.
PLYWOOD PANELS ARE TO BE AVAILABLE ON PREMISES.

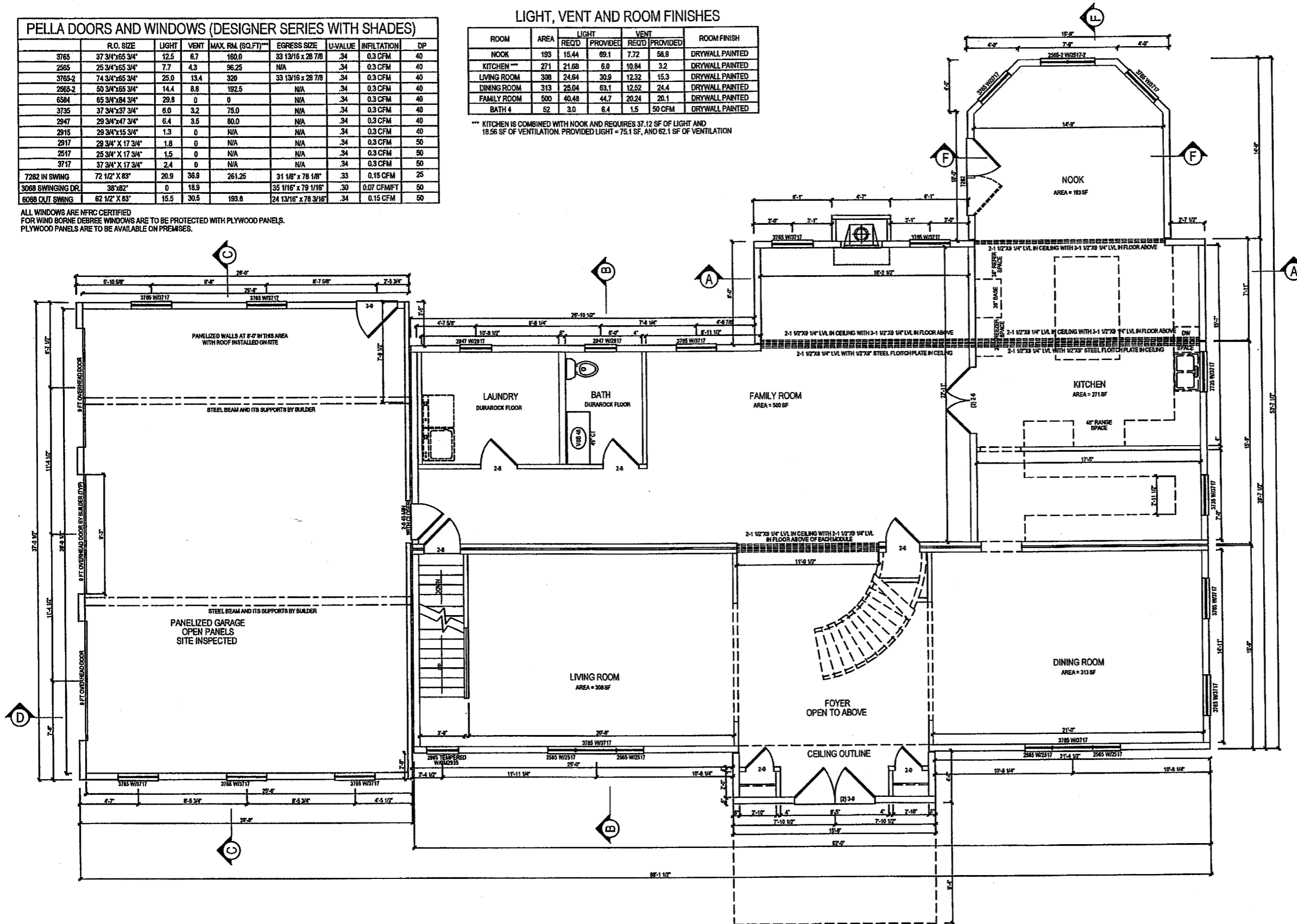

RESERVED DESIGN PROFESSIONAL SEAL

QUALITY ASSURANCE AGENCY APPROVAL STAMP

RESERVED FOR NEW YORK STATE APPROVAL STAMP

LIGHT, VENT AND ROOM FINISHES

ROOM	AREA	LIGHT		VENT		ROOM FINISH
		REQD	PROVIDED	REQD	PROVIDED	
BEDROOM 1	681	54.48	89.4	27.24	48.8	DRYWALL PAINTED
BEDROOM 2	275	22.0	26.9	11.0	15.3	DRYWALL PAINTED
BEDROOM 3	305	24.4	37.5	12.2	20.1	DRYWALL PAINTED
BEDROOM 4	282	22.56	37.5	11.28	20.1	DRYWALL PAINTED
PERSONAL OFFICE	131	10.48	12.5	5.24	6.7	DRYWALL PAINTED
BATH 1	231	3.0	5.4	1.5	3.0	DRYWALL PAINTED
BATH 2	99	3.0	ARTIFICIAL	1.5	50 CFM	DRYWALL PAINTED
BATH 3	69	3.0	7.3	1.5	3.9	DRYWALL PAINTED

STAIR NOTES:

1. ALL STAIR OPENINGS AND HEADERS ARE BASED ON BASEMENT CEILING HEIGHT OF 8'-0" UNLESS SHOWN OTHERWISE
2. RISE, RUN AND OPENINGS FOR STAIRS MAY VARY AS PLAN DESIGN VARIES. MAXIMUM RISER OF 8 1/4" MINIMUM TREAD OF 9" WITH AN 1 1/4" NOSING. STAIRS WILL HAVE MINIMUM HEAD ROOM OF 6'-8", MINIMUM WIDTH OF 3'-0"
3. BUILDER IS RESPONSIBLE TO INSTALL BASEMENT STAIRS, LANDINGS AND RAILINGS. RAILINGS
4. MAXIMUM VARIATION IN RISER HEIGHT BETWEEN 2 ADJACENT RISERS IS 3/16"
5. MINIMUM CLEARANCE FROM WALL TO HANDRAIL IS 1 1/2". HANDRAIL MAY PROJECT
6. LANDINGS SHALL BE AS WIDE AS STAIRS BUT NOT LESS THAN 3'
7. SWING OF DOOR OPENING ON A STAIRWAY SHALL NOT OVERLAP TOP STEP
8. ALL STAIR RAILINGS AND GUARD RAILS SHALL BE INSTALLED BEFORE DWELLING IS OCCUPIED.
9. 3 OR MORE RISERS SHALL BE PROTECTED BY HANDRAIL ON AT LEAST ONE SIDE.
10. OPEN SIDES OF STAIRS OR LANDINGS 18" OR MORE ABOVE ADJACENT FLOOR SHALL HAVE RAILINGS.
11. OPEN RAILINGS SHALL HAVE GUARDS BELOW RAILING THROUGH WHICH A 4" SPHERE CANNOT PASS.
12. STAIRWAY SHALL BE PROVIDED WITH ELUMINATION AND WITH A SWITCH IN BOTH DIRECTIONS.

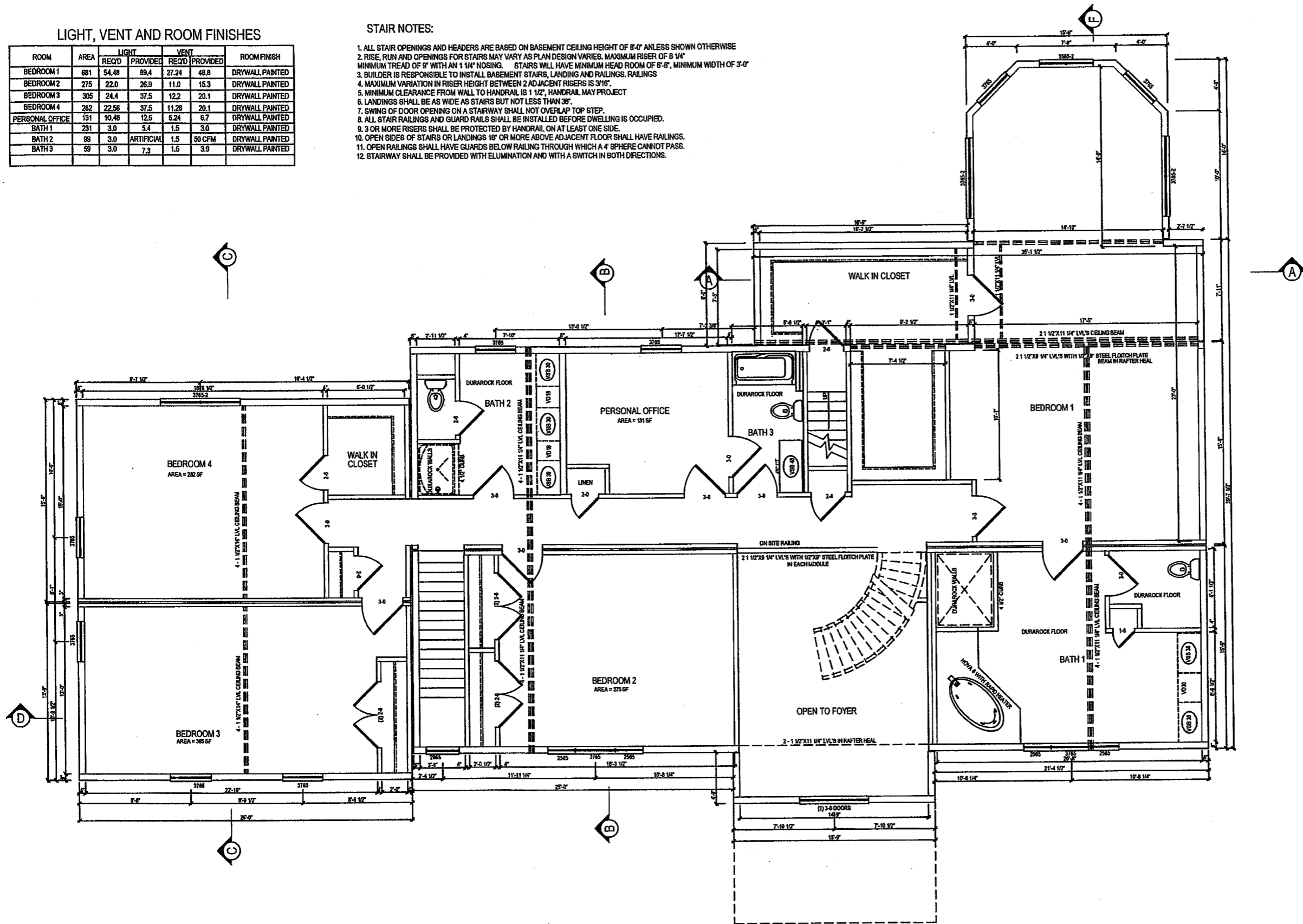

RESERVED DESIGN PROFESSIONAL SEAL

QUALITY ASSURANCE AGENCY APPROVAL STAMP

RESERVED FOR NEW YORK STATE APPROVAL STAMP